

EG1200

Electric Powerhead Owners Manual



P/N 8286-04

IMPORTANT SAFETY INSTRUCTIONS

Read These Instructions Before Using This Electric Powerhead

WARNING: To reduce the risk of fire, electrical shock or injury:

- Unplug and disconnect power before servicing.
- Do not use on wet surfaces.
- Do not allow to be used as a toy. Close attention is necessary when used by or near children.
- Use only as described in this manual. Use only manufacturer's recommended attachments.
- Do not use with damaged cord or plug. If appliance is not working as it should, has been dropped, damaged, left outdoors, or dropped into water, return it to an authorized servicing dealer.
- Do not pull or carry by cord, use cord as a handle, close a door on cord, or pull cord around sharp edges or corners. Do not run appliance over cord. Keep cord away from heated surfaces.
- Do not unplug by pulling on cord. To unplug, grasp the plug, not the cord.
- Do not handle system or appliance with wet hands.
- Do not put any object into openings. Do not use with any opening blocked. Keep openings free of dust, lint, hair and anything that may reduce airflow.
- Keep hair, loose clothing, fingers and all parts of body away from openings and moving parts.
- Do not pick up anything that is burning or smoking, such as cigarettes, matches or hot ashes.
- Turn off all controls before unplugging.
- Use extra care when cleaning on stairs.
- Do not use to pick up flammable or combustible liquids such as gasoline or use in areas where they may be present.
- Always turn off this appliance before connecting or disconnecting either hose or motorized nozzle.
- The hose contains electrical wires. Do not use if damaged, cut or punctured. Avoid picking up sharp objects.
- Do not leave vacuum or brush when plugged in. Unplug from outlet when not in use and before servicing.

SAVE THESE INSTRUCTIONS
Intended for Household Use Only

Parts & Features

It is important to know your vacuum cleaner's parts and features to assure its proper and safe use. Review these before using your cleaner.

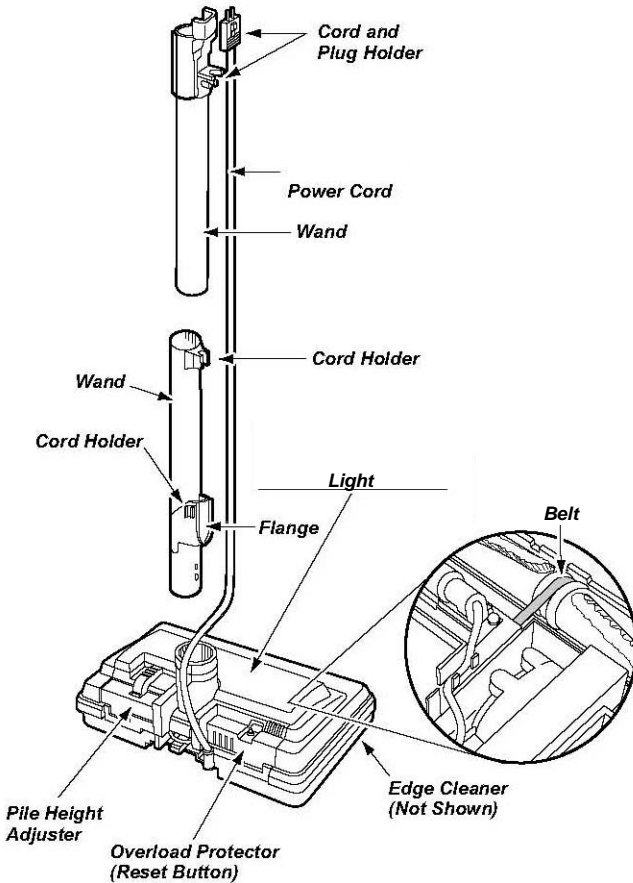

WARNING

Always unplug the EG1200 before cleaning the brush area as brush may suddenly restart. Failure to do so can result in personal injury.

Assembly Instructions

WARNING! Do NOT plug into electrical supply until assembly is complete. Failure to do so could result in electrical shock or injury.

1. Slide wands together until wand button 1 snaps into place.
2. Insert connected wands into the EG1200 until the wand button 2 snaps into place.
3. Secure cord into the cord holders on wand.
4. Connect EG1200 plug into the plug holder. (Fig. A) Do NOT force.

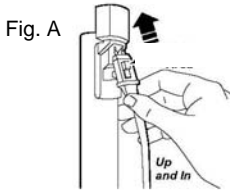

5. Insert the hose handle into the wand until the lock button snaps into place. (Fig. B) Be sure the hose is not twisted. To remove: Press handle release button and pull up on handle.

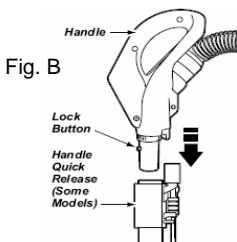

To remove wands: disconnect plug, steady EG1200 with foot and turn wands counterclockwise until the button disappears, then pull wands out of EG1200.

6. Insert the hose wall adapter into the vacuum inlet valve. Plug the 120V cord into the nearest electrical outlet if hose is equipped with a pigtail.

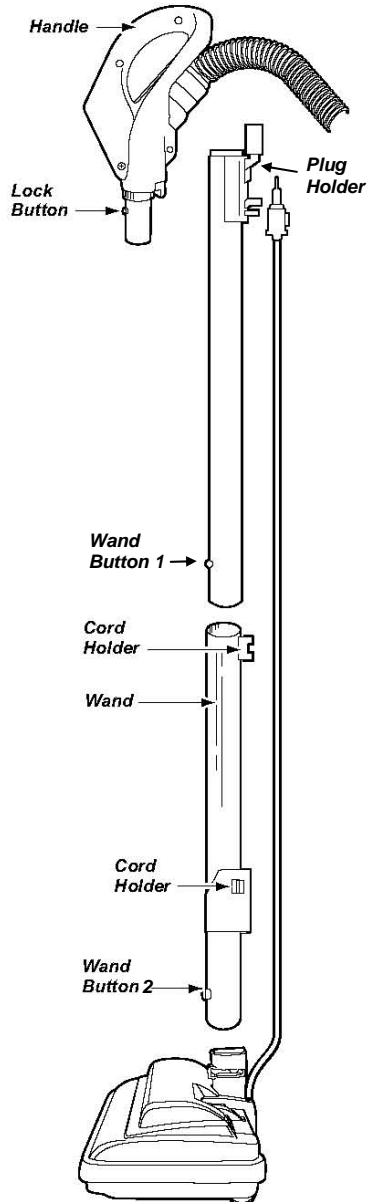

General Operation

- The EG1200 is controlled by the on/off power control switch located on the hose handle. The headlight will operate when the EG1200 is turned on.
- To lower wands, hold the EG1200 down with foot and pull back on wands.
- The powerhead has a pile height adjuster for various carpet heights. (Fig. C) Use the low setting for short napped carpets and the high setting for plush carpets.

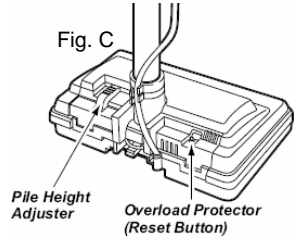

CAUTION: Do NOT leave the EG1200 running in one spot in the upright position for any length of time. Damage to carpet may occur.

Attachments

Using attachments on the hose handle:

1. Press lock button, then pull to remove handle from wand. (Fig. D) NOTE: if the EG1200 is attached, turn the powerhead off before removing handle from wands.
2. Slide attachments firmly on hose handle as needed. In some cases, the button may need to be depressed to allow the attachment to slide up higher where it can seal on the metal tube.

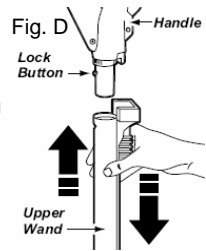

Using attachments on wands:

1. To remove the wands from the EG1200, lock wands in straight-up position. (Fig. E)
2. Remove EG1200 plug and cord from holders. (Fig. F)
3. Disconnect cord and steady the EG1200 with foot and turn wands until lock button disappears, then pull the wands out. (Fig. G)
4. Put attachment on wands as needed. In some cases, the button may need to be depressed to allow the attachment to slide up higher where it can seal on the metal tube.

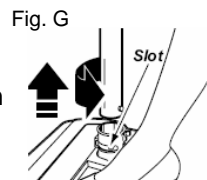
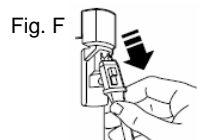
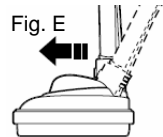

Performance Features

Edge Cleaner

Active brush edge cleaners are on both sides of the EG1200. Guide either side of the EG1200 along baseboards or next to furniture to help remove dirt trapped at carpet edges.

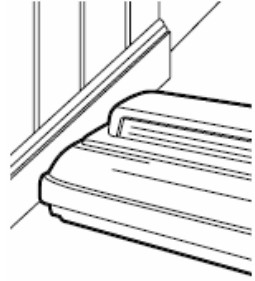

Overload Protector

The EG1200 has built-in protection against motor and belt damage should the brush jam. If the brush slows down or stops, the overload protector button pops up and shuts off the EG1200. The power unit will continue to run.



Suction Control

The suction control allows you to change the vacuum suction for different fabric and carpet weights. Opening the control decreases suction for draperies and lightweight rugs, while closing the control increases suction for upholsteries and carpets.



Maintenance and Care

WARNING!!! Disconnect electrical supply before servicing or cleaning the unit. Failure to do so could result in electrical shock or personal injury from cleaner suddenly starting. Always follow all safety precautions specified when caring for your EG1200.

Changing the Light Bulb

1. Remove the light cover by pressing in and lifting both sides as shown. (Fig. H)
2. Push in and turn bulb counterclockwise to remove. (Fig. I)
3. Replace the bulb. Bulb must not be higher than 15 Watts (130 Volts). Close light cover until it snaps in place.

Fig. H

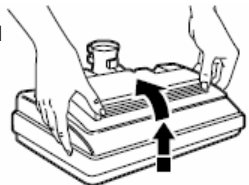
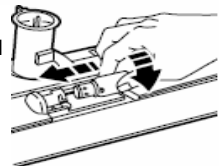

Fig. I



Maintenance and Care

Belt Changing & Brush Cleaning

Disconnect hose and brush from electrical outlet. Frequently check and remove hair, string and lint buildup in the brush and brush support areas. If buildup becomes excessive, disconnect the EG1200 from the wands and follow the steps below.

To remove belt:

1. Remove light cover and light bulb. Turn EG1200 over, raise pile height adjuster rollers and remove the 2 screws from the base. (Fig. J)

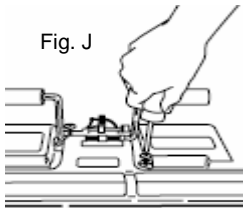

2. Insert and twist flat screwdriver under both back cover tabs. (Fig. K)

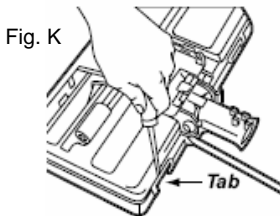

3. Turn EG1200 right side up. Tilt cover forward from back until front snaps free. (Fig. L)

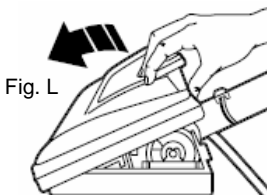

4. Carefully insert and lift screwdriver at each brush support to free brush from base. (Fig. M)

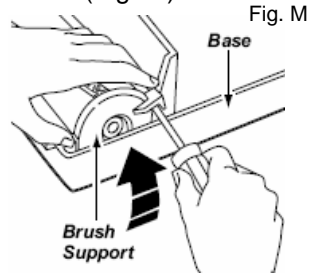

5. Remove belt from motor shaft. (Fig. N)

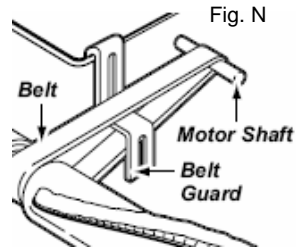

6. Remove worn belt. (Fig. O)

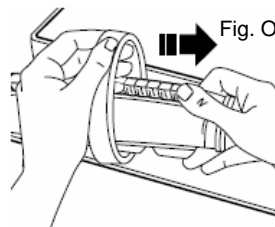

Maintenance and Care

To Replace Belt:

1. Install new belt (part # 8581-01) in belt groove on the brush assembly, the over the motor shaft. Be sure belt is under the belt guard. (Fig. P)

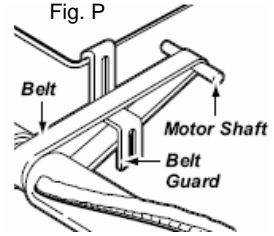

2. Insert both support tabs into the base slots. Then snap brush supports into place. (Fig. Q)

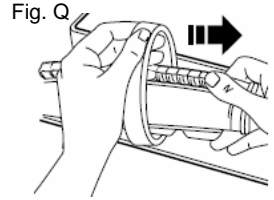

3. Line up tabs on front of base with slots inside the front cover. (Fig. R)

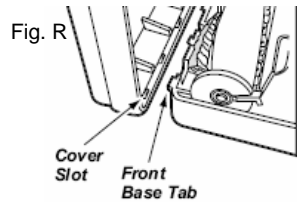

4. Tilt cover to back. Press cover firmly until rear tabs snap into place. (Fig. S)

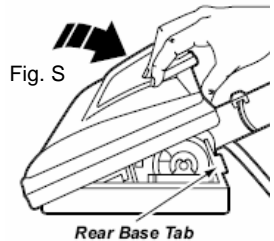

5. Turn EG1200 over. Replace cover screws and lower the pile height adjustment rollers into place. Replace light bulb and cover.

EG1200 Explosion & Parts List

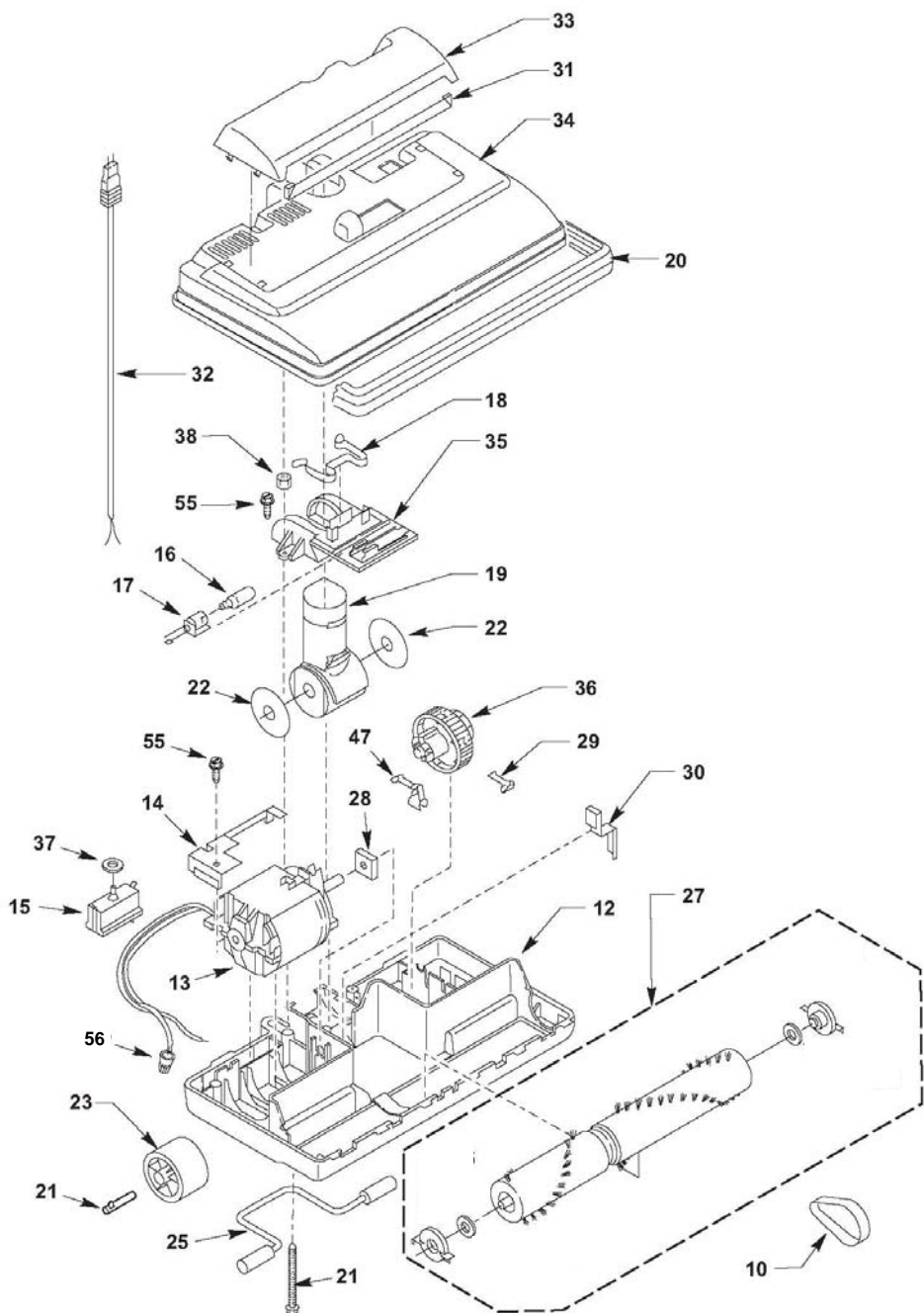

Illustration #	H-P Part #	Description
10	8581-01	Belt
12	8973	Nozzle Base
13	8974	Motor
14	8975	Motor Bracket
15	7941	Overload Protector
16	7967	Bulb, light (15 Watt)
17	8978	Bulb Socket
18	8979	Catch, Yoke
19	8980	Swivel
20	8981	Bumper
21	8982	Roller Shaft
22	8983	Seal, Yoke Bearing
23	8984	Nozzle Wheel
24	8985	Screw, Base
25	8986	Axle Roller
27	8988	Brush Assembly
28	8989	Seal, Motor Shaft
29	7951	Ratchet Catch
30	8991	Belt Guard
31	8992	Lens, Light Panel
32	8993	Cord
33	8994	Panel Light (includes item 31)
34	8995	Floor Nozzle, Upper
35	8996	Swivel Cap
36	8997	Indicator Cam
37	8998	Overload Seal
38	8999	On-Sert
47	7939	Lifter
55	7958	Screw, 8-18 x 1-1/2
56	7966	Wire Connector

LIMITED WARRANTY

H-P PRODUCTS, INC. warrants that the EG1200 Electric Powerhead, when used for household purposes, pursuant to Seller's instructions, will be free from defects in materials and workmanship for a period of one (1) year from the date of the initial consumer purchase. H-P PRODUCTS, INC. warrants that the EG1200 Electric Powerhead, when used in a commercial application, pursuant to Seller's instructions, will be free from defects in materials and workmanship for a period of ninety (90) days from the date of the initial sale by H-P PRODUCTS, INC. This warranty is limited to the replacement of defective parts and any costs of shipping shall be incurred by the purchaser.

THIS WARRANTY IS EXCLUSIVE AND IS IN LIEU OF ALL OTHER WARRANTIES, EXPRESS, IMPLIED, OR STATUTORY, AND H-P PRODUCTS, INC. SPECIFICALLY DISCLAIMS RESPONSIBILITY FOR CONSEQUENTIAL AND INCIDENTAL DAMAGES, AND LIMITS THE IMPLIED WARRANTY OF MERCHANTABILITY TO THE PERIOD OF EFFECTIVENESS OF THIS EXPRESS WARRANTY.

**H-P Products, Inc.
512 W. Gorgas Street
Louisville, OH 44641
www.centralvacservice.com**